

EMPLOYEE SHARED USE FUNCTIONALITY with BOLT

LOCK INTERFACE OVERVIEW

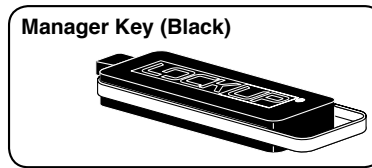

- Provides management access
- Provides external power
- Up to 25 keys may be registered to each lock

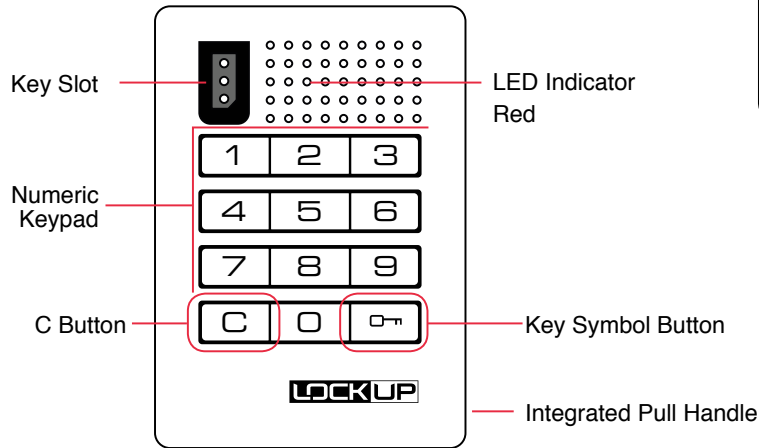
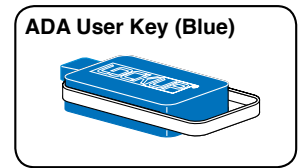

- ADA Compliant User Key
- Optional

OPERATE WITH A USER CODE

Note: Lock will automatically unlock after 12 hours of non-use.

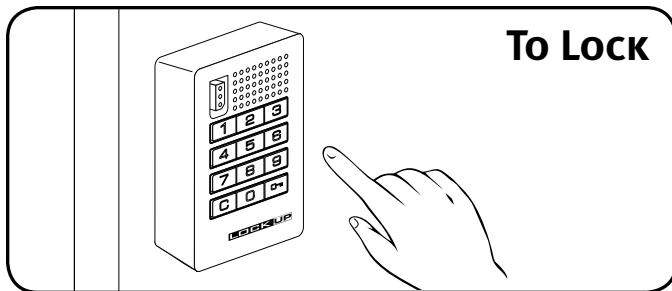

- 1) Close the door.
- 2) Press: **C** (any 4-digit user code) **Key Symbol**

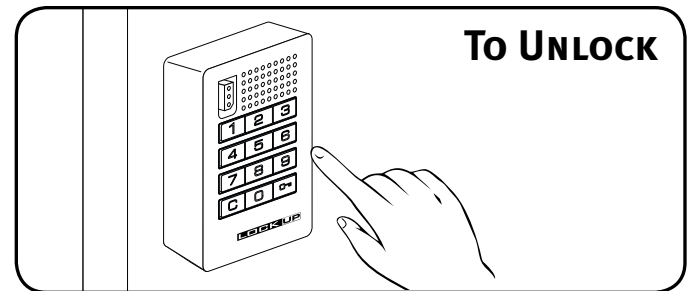

- 1) Press: **C** (same 4-digit user code) **Key Symbol**
- 2) Open the door.

Note: After three consecutive incorrect user code entries, the lock will go into “Sleep State” for one minute or until a registered Manager Key is used to operate the lock.

OPERATE WITH AN ADA USER KEY

The ADA User Key is designed to be used by persons with disabilities and is 100% ADA Compliant.

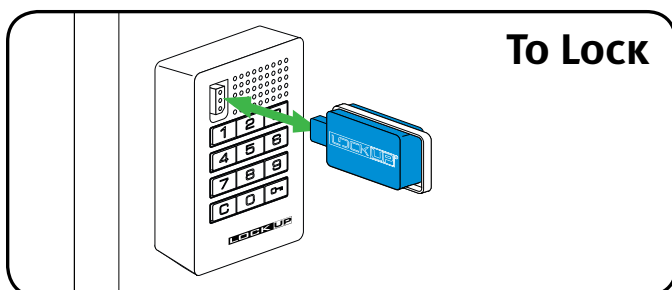

- 1) Close the door.
- 2) Touch any ADA User Key to key slot.

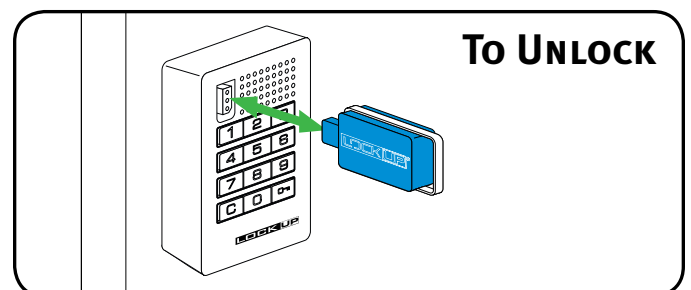

- 1) Touch the same ADA User Key to key slot.
- 2) Open the door.

TO OPERATE WITH A MANAGER KEY

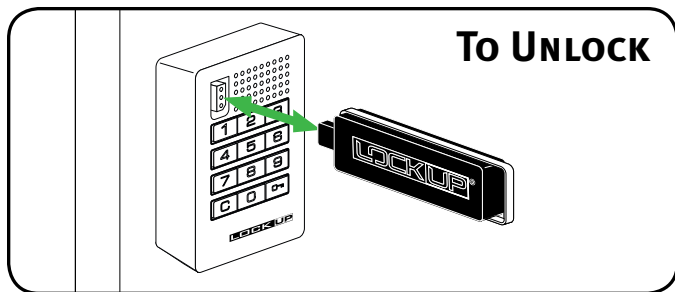

- 1) Touch a registered Manager Key to key slot.
- 2) Open the door.

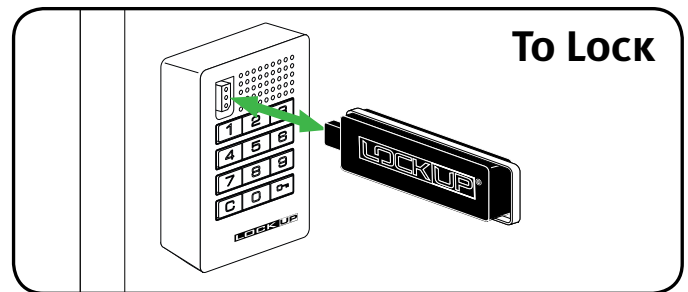

- 1) Close the door.
- 2) Touch a registered Manager Key to key slot.

PROGRAMMING GUIDE

INITIALIZING NEW LOCKS

Note: In most instances this product is pre-initialized with the Manager Key. The initializing instructions are only applicable if the locks are working with the factory default code of **C** button followed by **□** button.

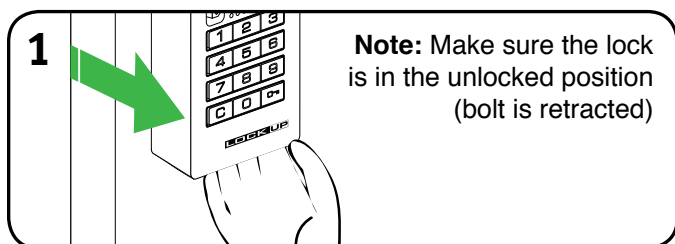

Go to a new lock.

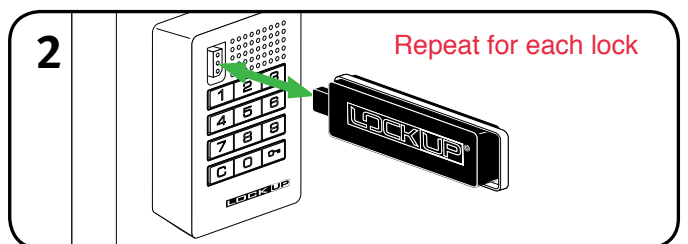

Touch the Manager Key to the key slot for one second.

NOTE: Depending on the bolts position, the bolt will extend or retract and will emit a two tone beep and a single LED flash, signaling that the lock has successfully accepted the Manager Key(s) and is now initialized.

REPLACE MANAGER KEY(S)

Note: The following steps will erase all previous registered Manager Key(s) per lock.

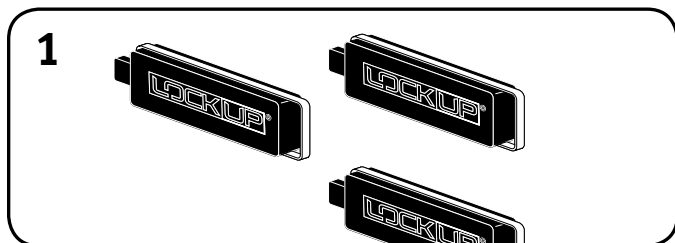

- 1) It is recommended to gather all your Manager Key(s).
- 2) Contact a LockUp Product Support Representative to order a replacement Manager Key.

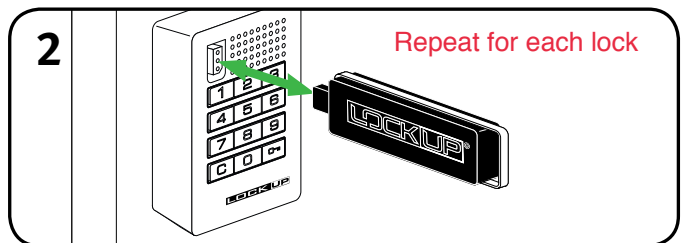

Touch the replacement Manager Key to the key slot for one second.

NOTE: Depending on the bolts position, the bolt will extend or retract and will emit a two tone beep and a single LED flash, signaling that the lock has successfully accepted the replacement Manager Key(s).

For additional product information including instructional videos please visit us online at: www.lockup.com

Via email: support@lockup.com
Phone: (707) 766-6000
Fax: (707) 766-6226

LockUp ®
9 Willowbrook Court
Petaluma, CA 94954

2/08/13

