

DUAL USE FUNCTIONALITY with BOLT

LOCK INTERFACE OVERVIEW

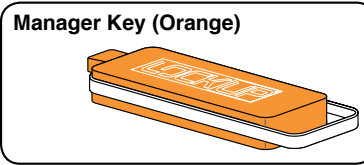

- Provides management access
- Provides external power
- Up to 20 keys may be registered to each lock

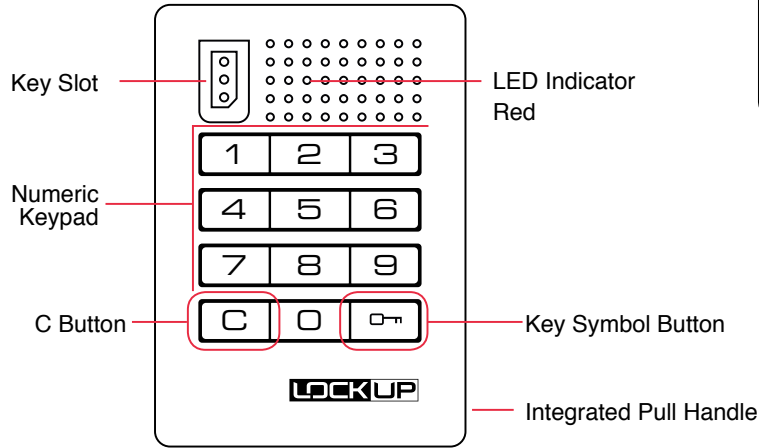
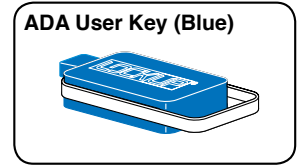

- ADA Compliant User Key
- Optional

INITIALIZING NEW LOCKS

Note: In most instances this product is pre-initialized with the Manager Key. The initializing instructions are only applicable if the locks are working with the factory default code of **C** button followed by **0π** button.

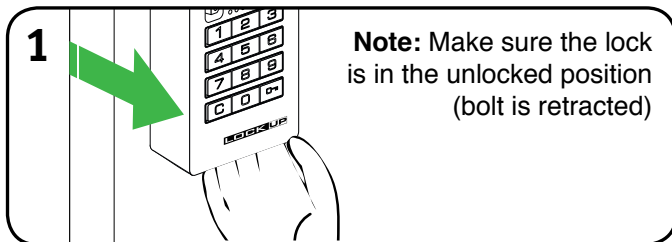

Go to a new lock.

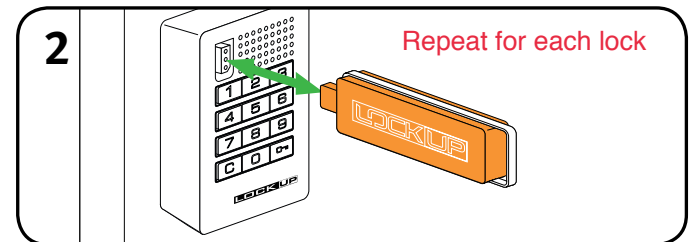

Touch the Manager Key to the key slot for one second.

NOTE: Depending on the bolts position, the bolt will extend or retract and will emit a two tone beep and a single LED flash, signaling that the lock has successfully accepted the Manager Key(s) and is now initialized.

CHANGE LOCK USE FUNCTION

NOTE: Locker door must be open and LockUp lock must be in the unlocked position for these steps.

CHANGE TO SHARED USE FUNCTION

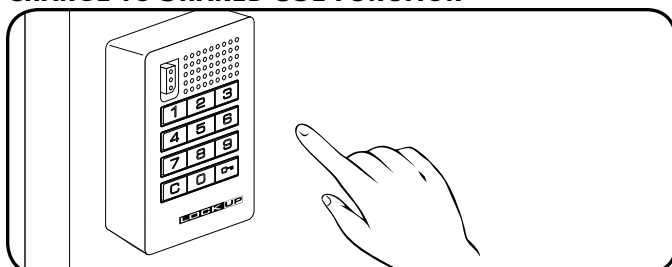

- 1) Press: **C** **0π**
- 2) Enter: (manager code) **0π**
A two tone beep will be heard and a green LED light will turn solid.
- 3.) Press: **2** (Shared Use Function) then press: **0π**
A two tone beep will be heard and a red LED light will flash indicating status has changed.

CHANGE TO ASSIGNED USE FUNCTION

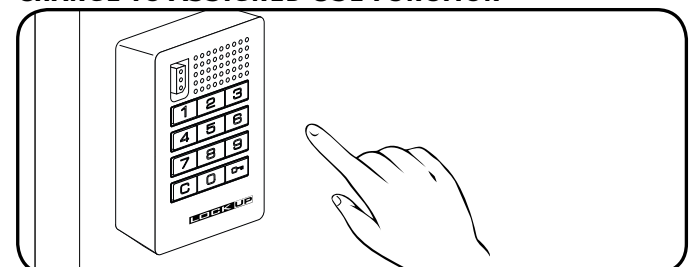

- 1) Press: **C** **0π**
- 2) Enter: (manager code) **0π**
A two tone beep will be heard and a red LED light will turn solid.
- 3) Press: **1** (Assigned Use Function) then press: **0π**
A two tone beep will be heard and a green LED light will flash indicating status has changed.

ASSIGNED USE - OPERATING INSTRUCTIONS

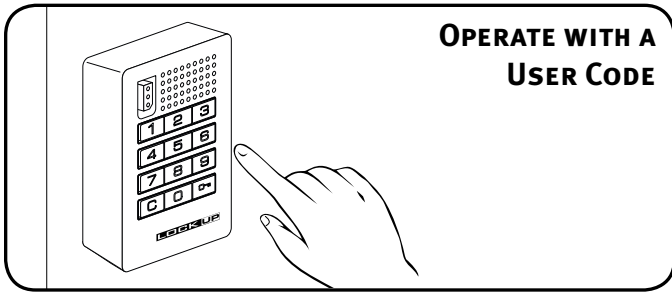

To Unlock: [C] (assigned user code) [0] [π]
To Lock: [0] [π]

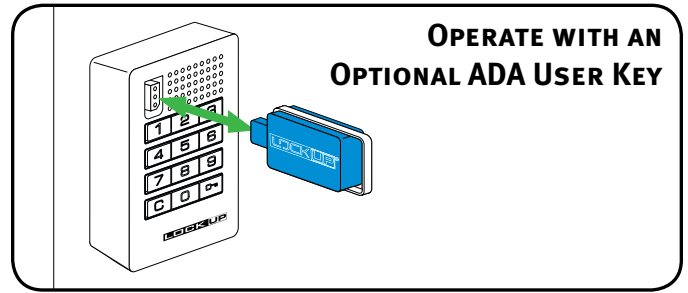

To Unlock: Touch a registered User Key to Key Slot.
To Lock: [0] [π]

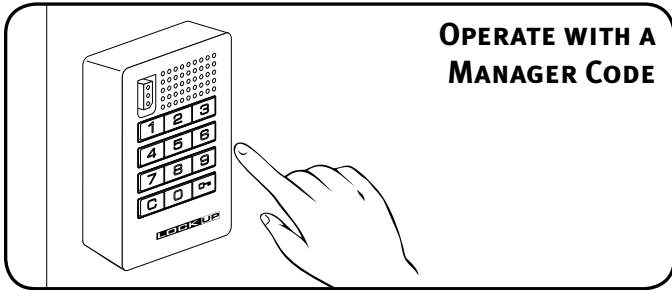

To Unlock: [C] (manager code) [0] [π]
To Lock: [0] [π]

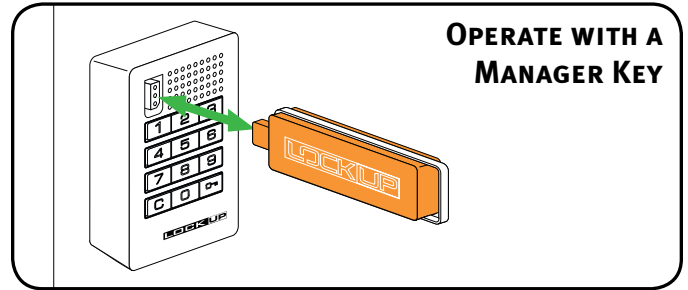

To Unlock: Touch a registered Manager Key to Key Slot.
To Lock: [0] [π]

SHARED USE - OPERATING INSTRUCTIONS

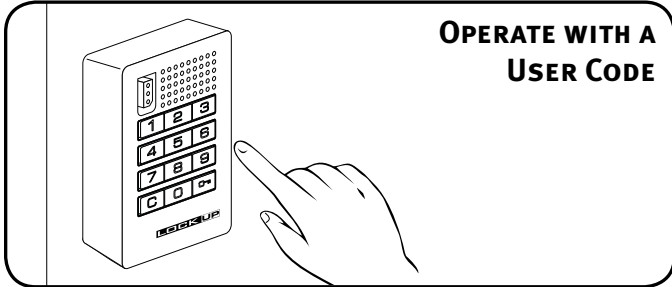

To Lock: [C] (any 4-digit code) [0] [π]
To Unlock: [C] (same 4-digit code) [0] [π]

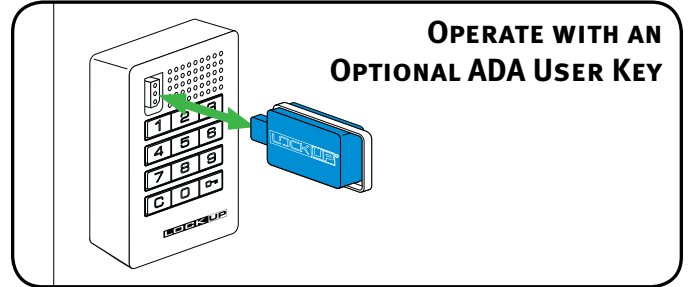

To Lock: Touch any User Key to Key Slot.
To Unlock: Touch same User Key to Key Slot.

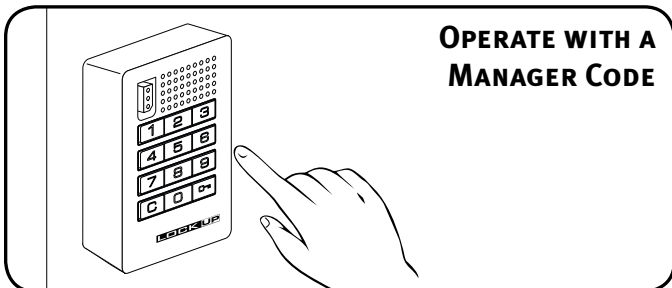

To Lock: [C] (manager code) [0] [π]
To Unlock: [C] (manager code) [0] [π]

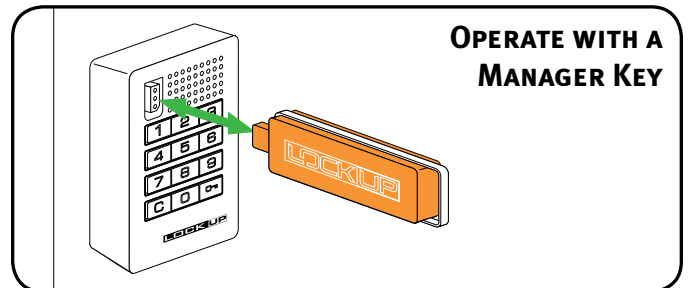

To Lock: Touch a registered Manager Key to Key Slot.
To Unlock: Touch a registered Manager Key to Key Slot.

For additional product information including instructional videos please visit us online at: www.lockup.com

Via email: support@lockup.com
Phone: (707) 766-6000
Fax: (707) 766-6226

LockUp®
 9 Willowbrook Court
 Petaluma, CA 94954

1/31/13

